

Revisions			
Rev.	Description	Date	Mod. by
1	Aggiornato disegno	09/07/2024	M.S.

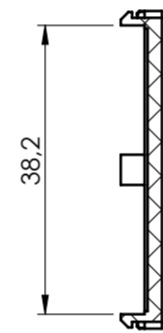

SECTION A-A

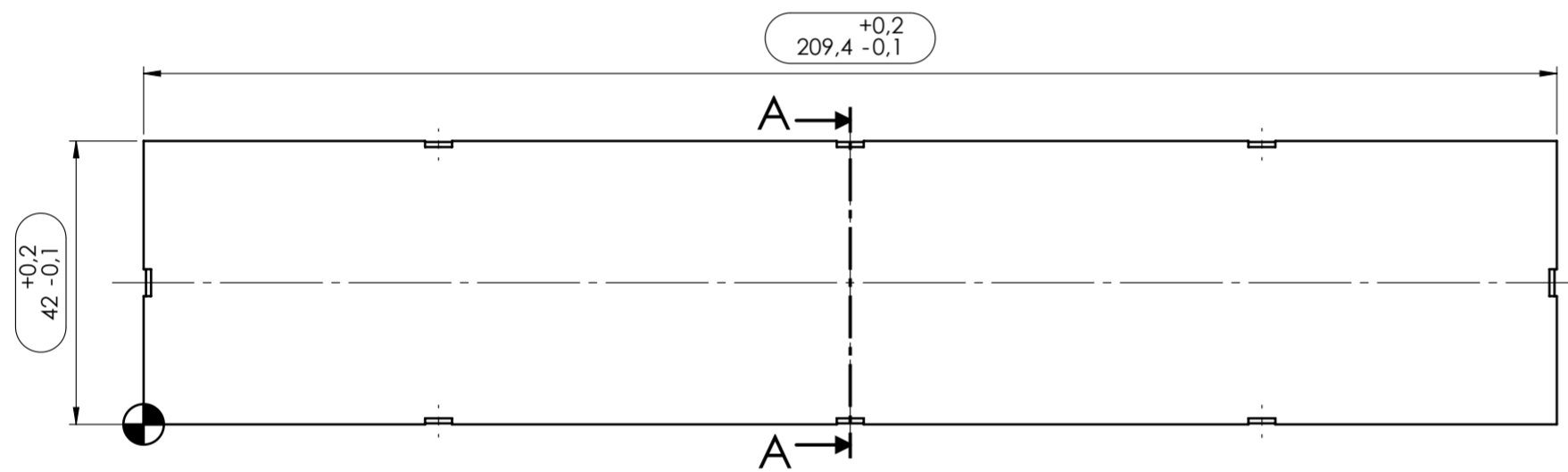
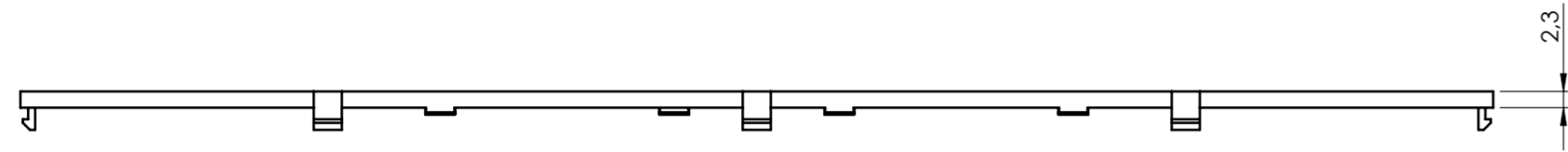
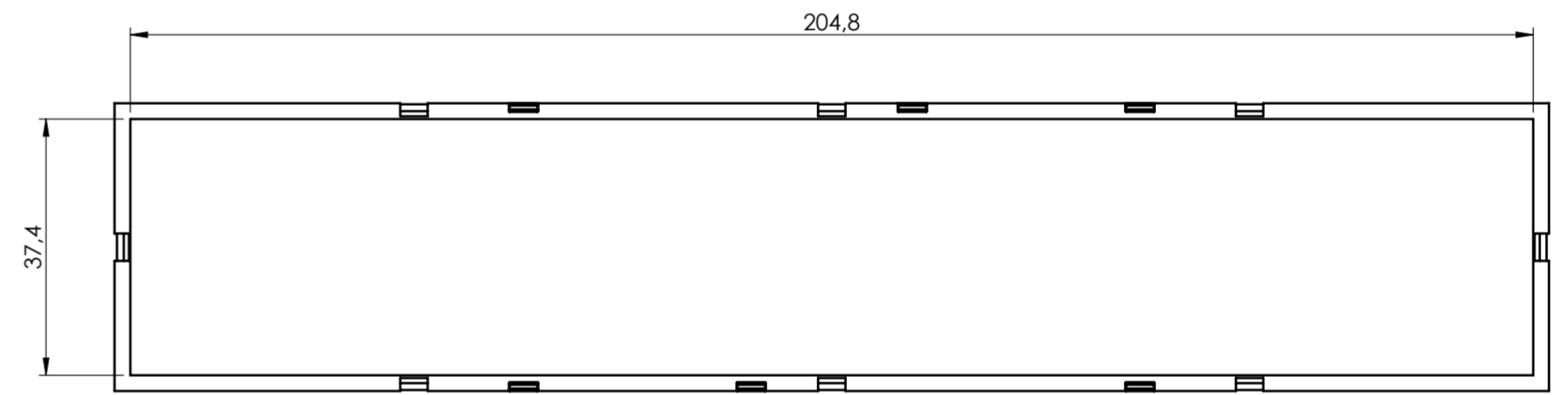

General information:  
 - Workpiece zero point for mechanical processing  
 - Minimum recommended radius for machining = R1.0 mm

General Tolerance UNI EN 22768/1 Media (m)						Sheet:
from 0.5 to 3 ± 0.1	from 3 to 6 ± 0.1	from 6 to 30 ± 0.2	from 30 to 120 ± 0.3	from 120 to 400 ± 0.5		1
Scale:	IM:	Drawn:	Checked:	Date:	Material:	Process:
1:1	--	R.N.	R.N.	17/05/2023	PC/ABS-PC	INJECTION
	The present drawing cannot be reproduced or communicated to 3rd parties, even partially, without the authorization of Italtronic. Italtronic reserves the right to modify the drawings according to the law.		Replaces the:	Derived from:	Weight:	Cod. Mold:
Dimension in mm			M-01978-02	--	20.69 gr	ST.0511400

**italtronic**  
 enclosures for electronics  
 italtronic.com

Description:  
 PANNELLO MODULBOX SENZA CORNICE 12M  
 PANEL MODULBOX WITHOUT FRAME 12M

Drawing nr.: **2\_250\_03698**

Rev.: **01** A2