

General information:  
 ● Workpiece zero point for mechanical processing  
 - Minimum recommended radius for machining = R1.0 mm  
 - Mounting rail like EN 60715: TH 35-7.5 or TH 35-15  
 - Recommended PCB outline on [www.italtronic.com](http://www.italtronic.com)

RIF.	Q.TY	DRAWING	DESCRIPTION
1	1	2_250_03627	BASE MODULBOX XT-XTS 12M
2	2	2_250_00072	HOOK FOR MODULBOX XT-XTS
3	1	2_250_03694	BODY ENCLOSURE XTS 12MH53V-A

General Tolerances (UNE EN 22768/1 Medio [mm])

Dimension in mm	from 0.5 to 3	from 3 to 6	from 6 to 30	from 30 to 120	from 120 to 400
±0.1	±0.1	±0.2	±0.3	±0.5	

Scale: 1:1  
 Drawn: R.N.  
 Checked: 18/05/2023  
 Date: 18/05/2023  
 Material:  
 Process:  
 Weight: gr  
 Cod. Mod: --

Dimension in mm

italtronic  
 enclosures for electronics  
 3\_250\_00120  
 00 A1

PCB A

Max height of the terminal:  
Modulbox XT/XTS: 18.5 mm  
Modulbox ONE: 20 mm

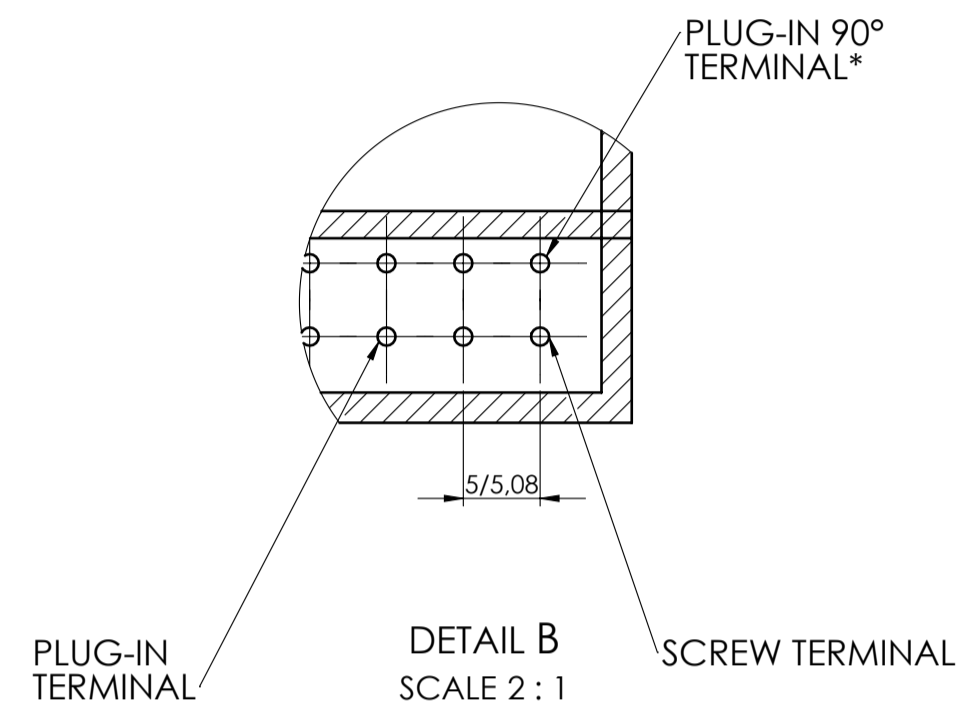
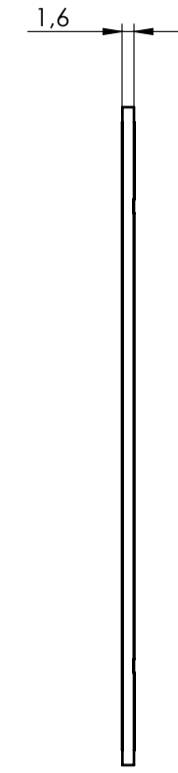
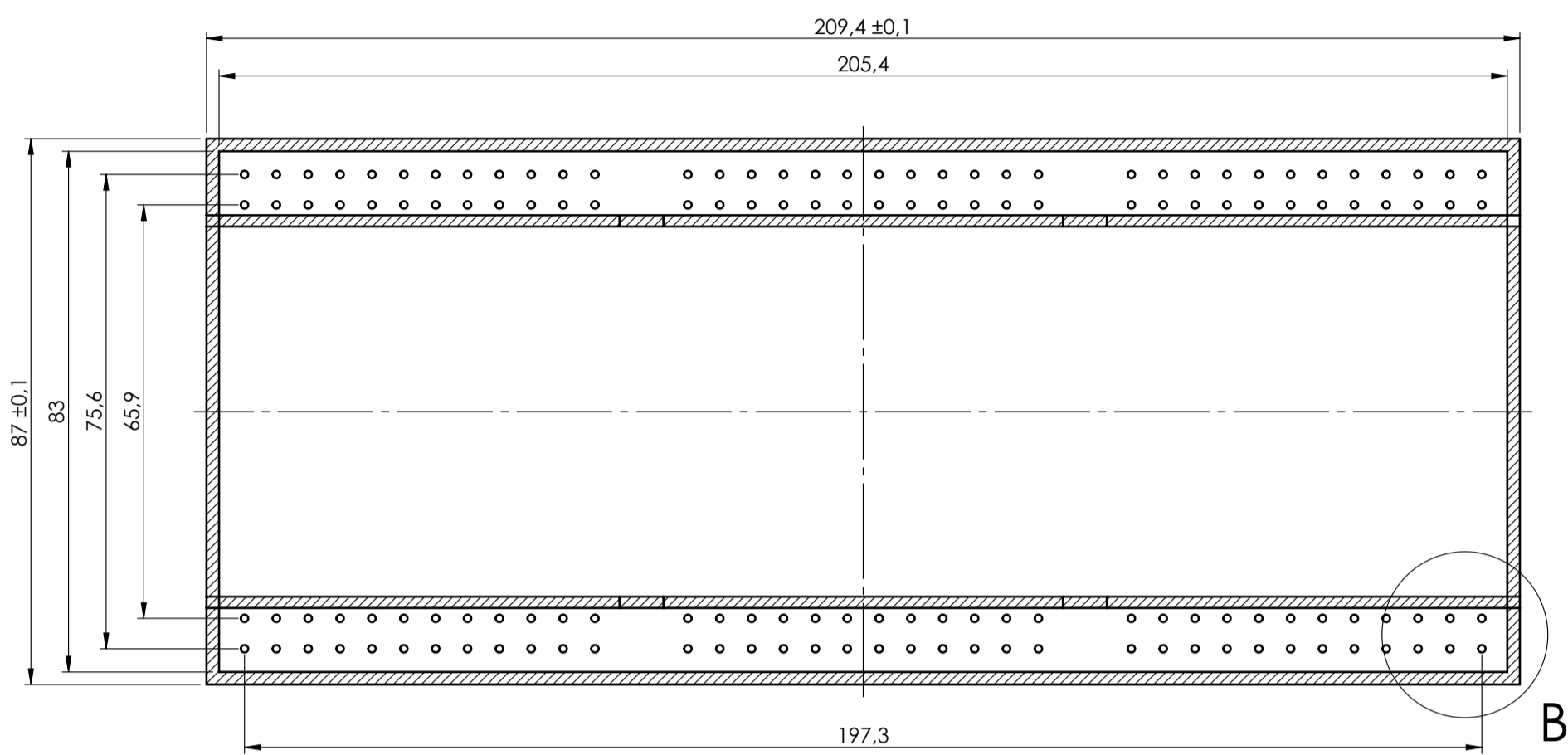

\*To use the PLUG-IN terminals in Modulbox ONE use plug-in adapter P03000003E (5/5.08 pitch) and P03000004E (7.5/7.62 pitch)

PCB B

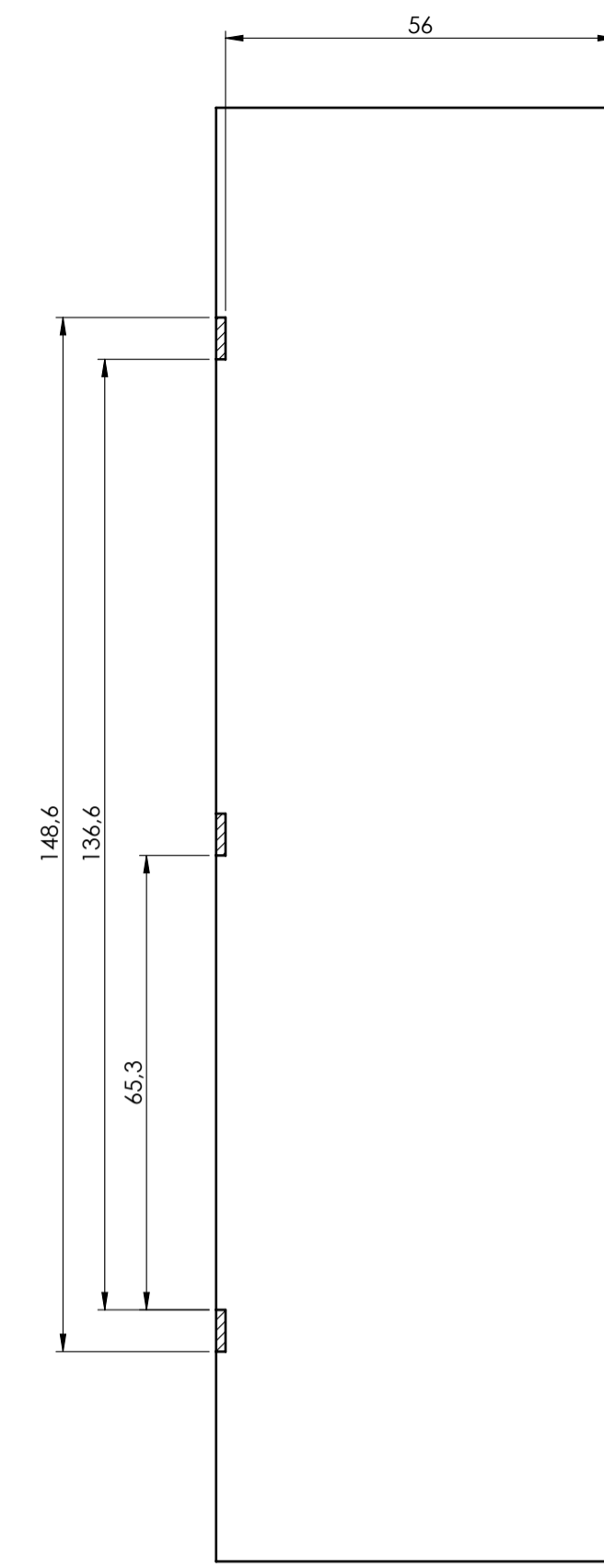
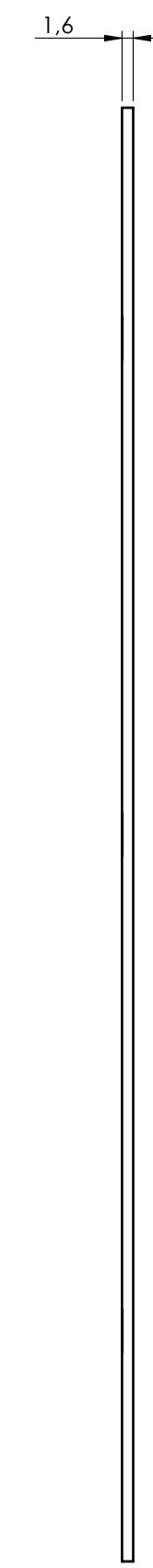
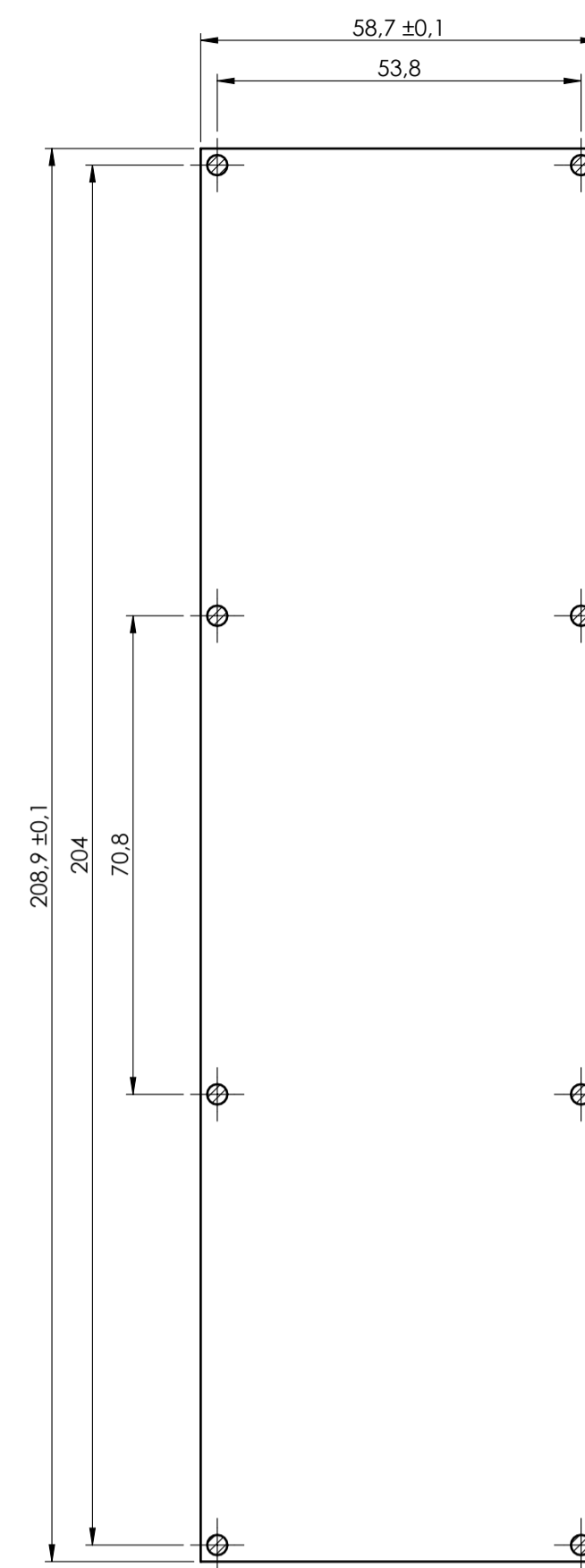

PCB C

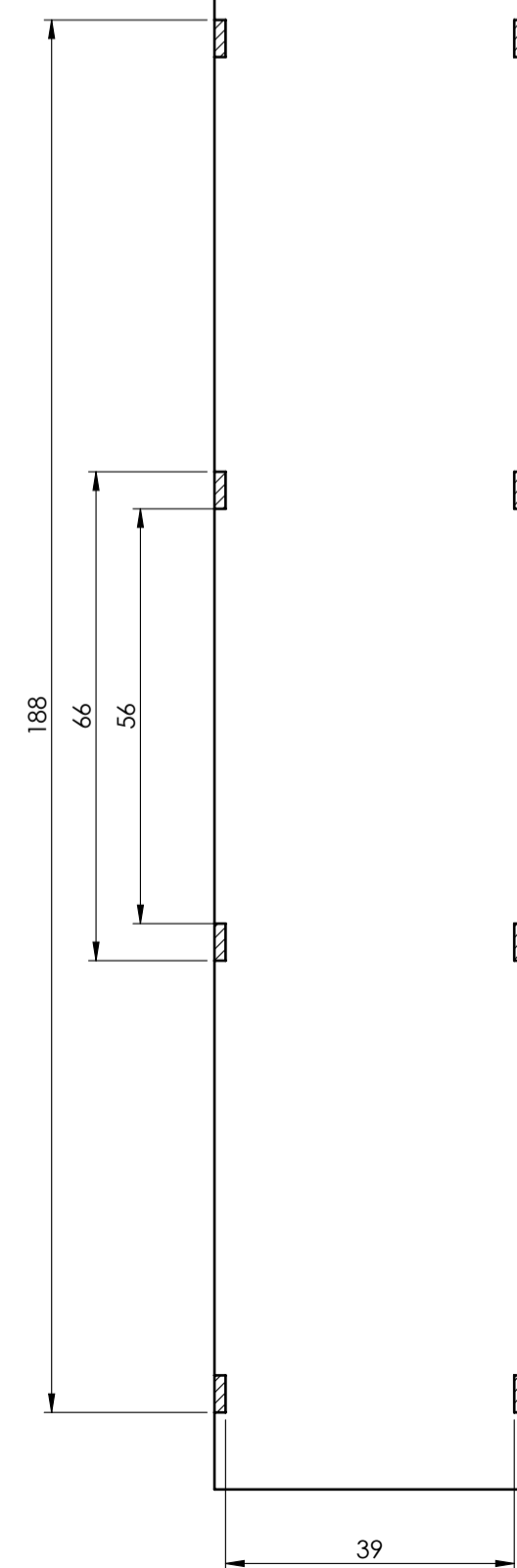
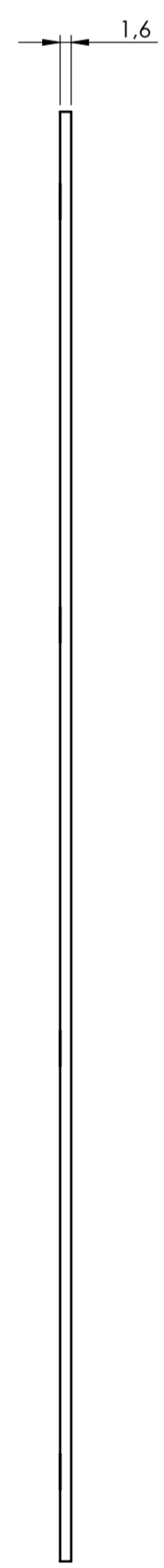
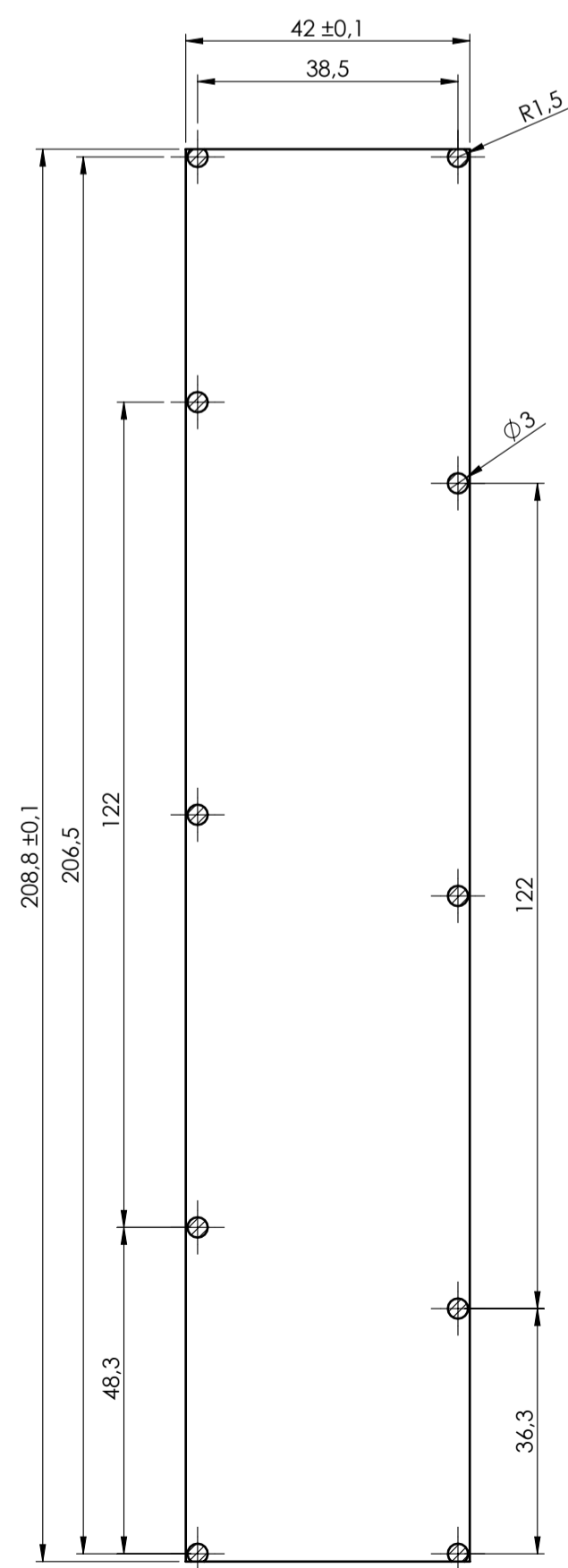

PCB V2

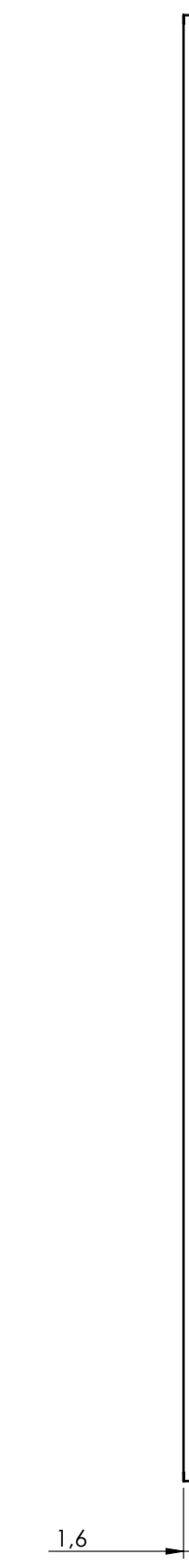
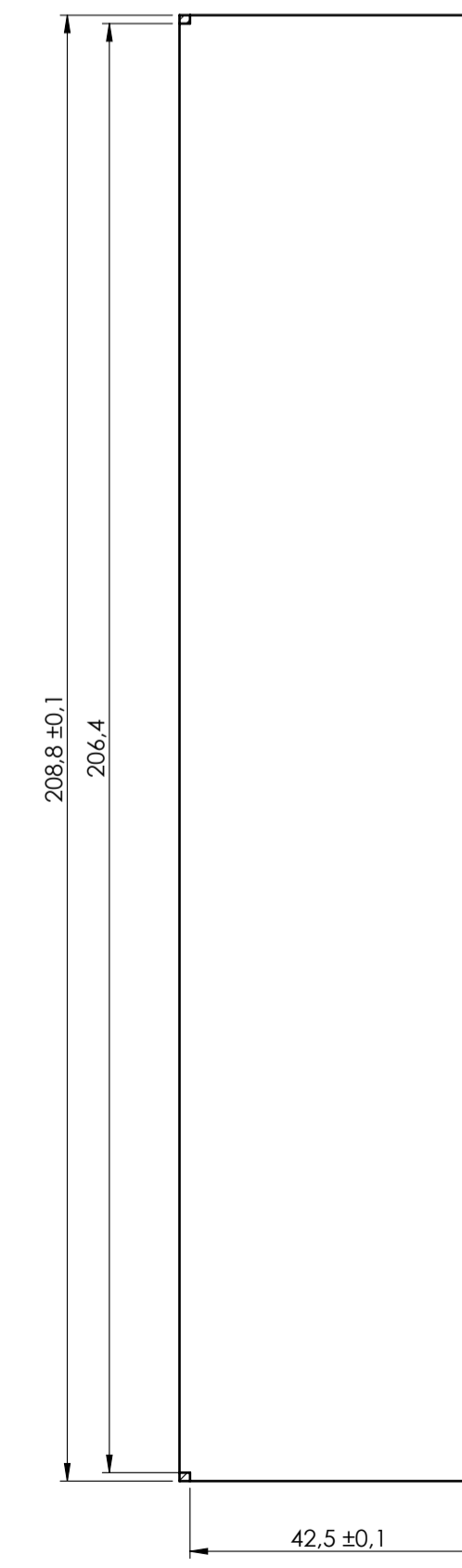

General Tolerance IIR EN 22768/1 Media (m)				Sheet:	
from 0.5 to 3 ± 0.1	from 3 to 6 ± 0.1	from 6 to 30 ± 0.2	from 30 to 120 ± 0.3	from 120 to 400 ± 0.5	PCB
Scale:	Drawn:	Checked:	Date:	Material:	Process:
1:1		R.N.	18/05/2023		
Dimension in mm			Derived from:	Weight:	Cod. Mod:
				gr	--
Description:			Rev.:		
KIT CONTENITORE MODULBOX XTS 12MH53V-A VENTILATO			00 A1		
KIT ENCLOSURE MODULBOX XTS 12MH53V-A WITH VENTS			3_250_00120		
Italtronic			italtronic.com		

NO COMPONENTS AREA